





# AC1200 Wi-Fi Router MU-MIMO Gigabit

Full Gigabit | Dual Band



Archer A6

 867 Mbps 5 GHz +  
400 Mbps 2.4 GHz†

 Faster Wi-Fi  
with MU-MIMO

 Supports Smart  
Roaming

# Highlights

## Convenient Mesh Networking

Mesh networking creates smooth, fast, stable roaming. Archer A6 can build an EasyMesh network with routers that use EasyMesh technology. It also works with other TP-Link OneMesh products to create a TP-Link OneMesh network. Eliminate Wi-Fi dead zones, expand your network, and fill your entire home with high-speed Wi-Fi.

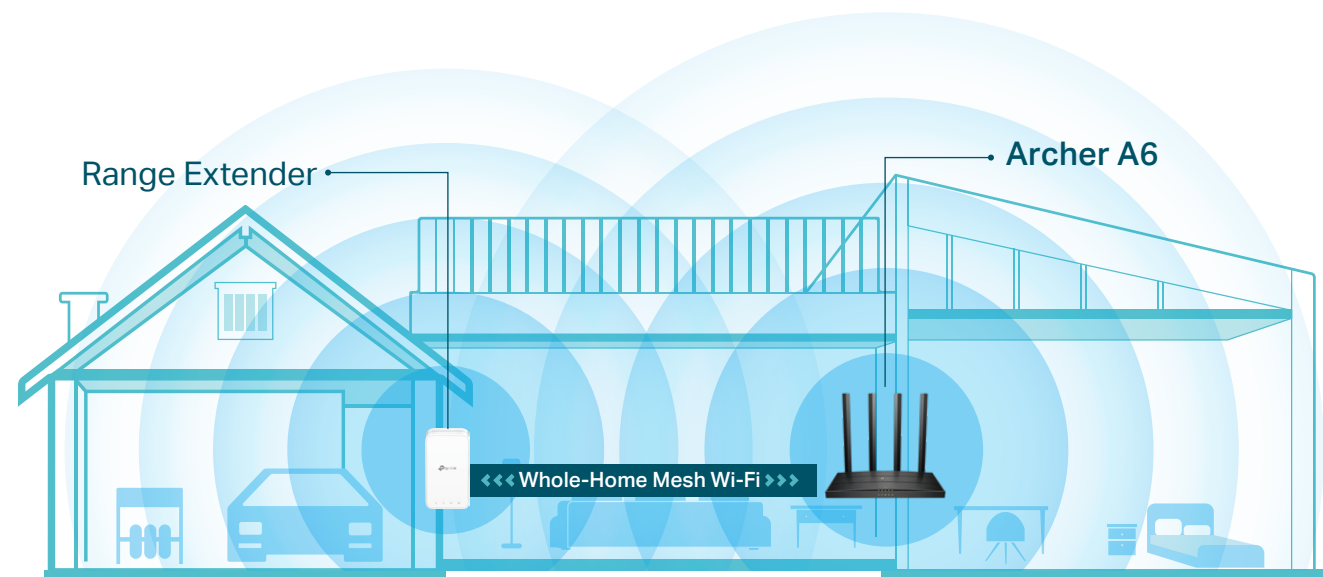

## 10× Faster Connectivity

One Gigabit WAN port and four Gigabit LAN ports deliver speeds up to 10× faster than standard Ethernet connections. Let every member of your family simultaneously enjoy high-speed network on their phones, tablets and laptops.†

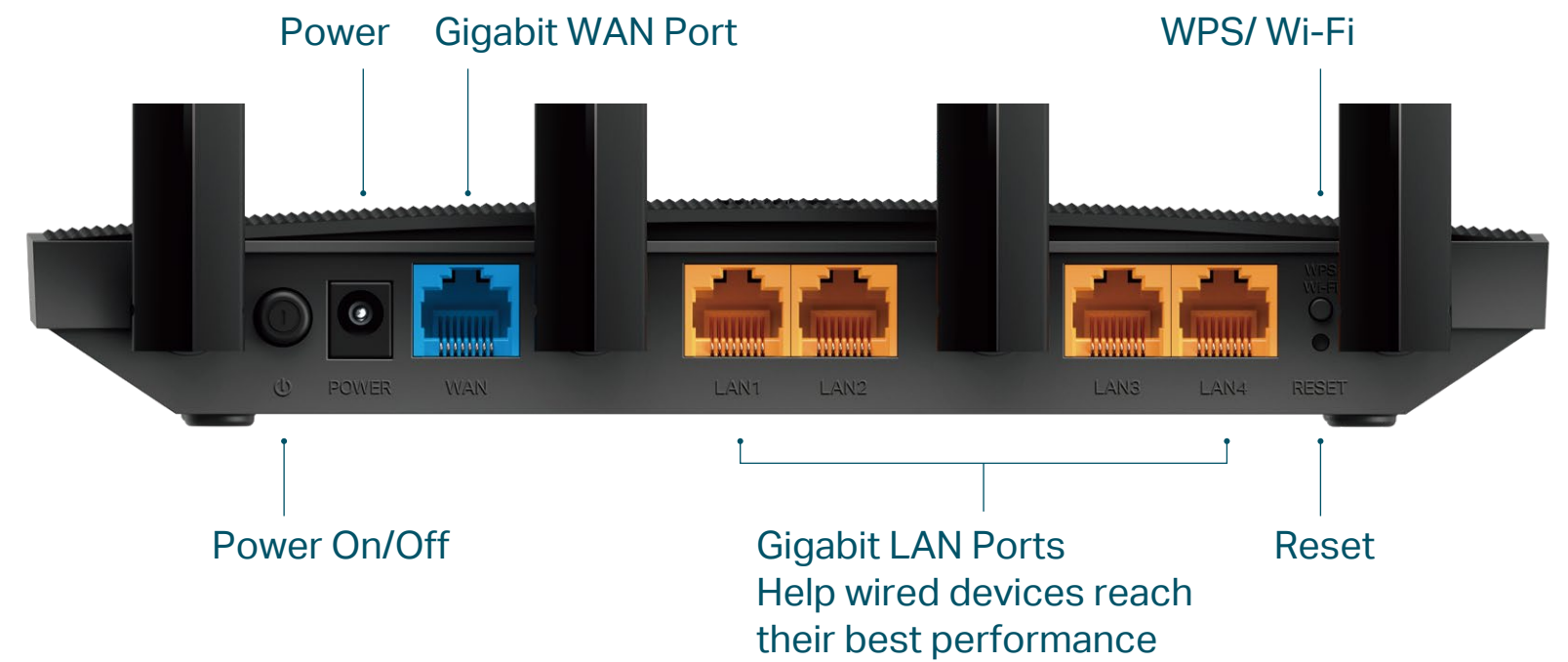

# Highlights

## Personalized Management

Block inappropriate content and set daily limits for the total time children/staff spend online through Parental Controls. Guest Network creates a separate access point for guests, to ensure your privacy is secure.

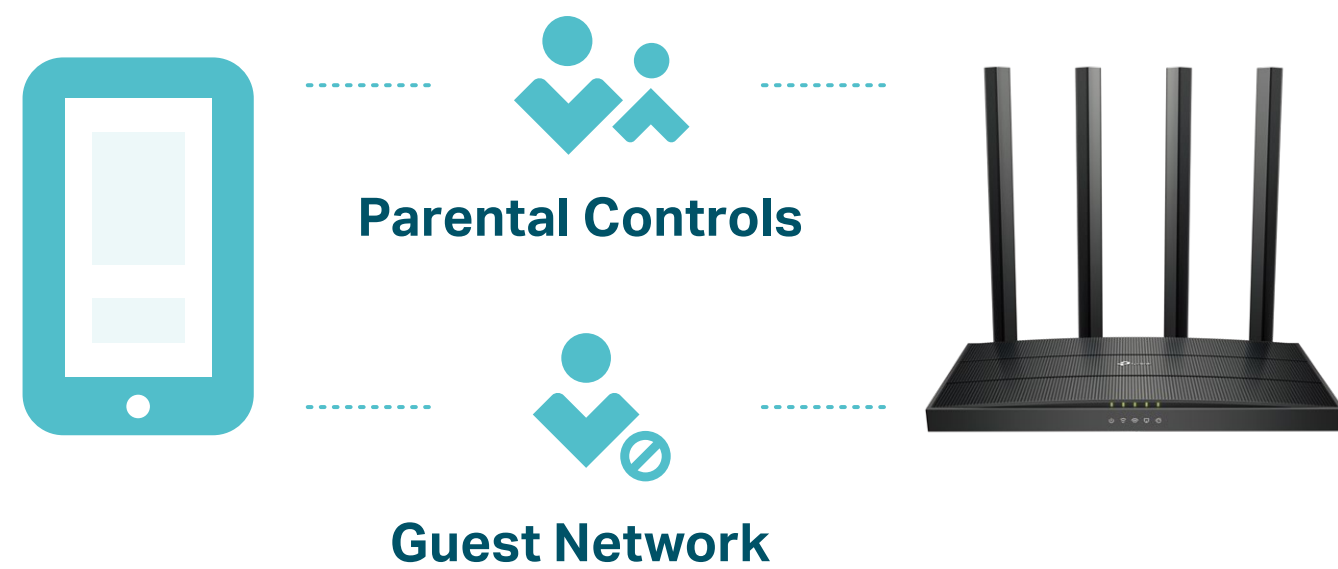

## MU-MIMO

MU-MIMO technology serves multiple devices at once, reducing wait time, increasing Wi-Fi throughput for every device, and making each stream more efficient.‡

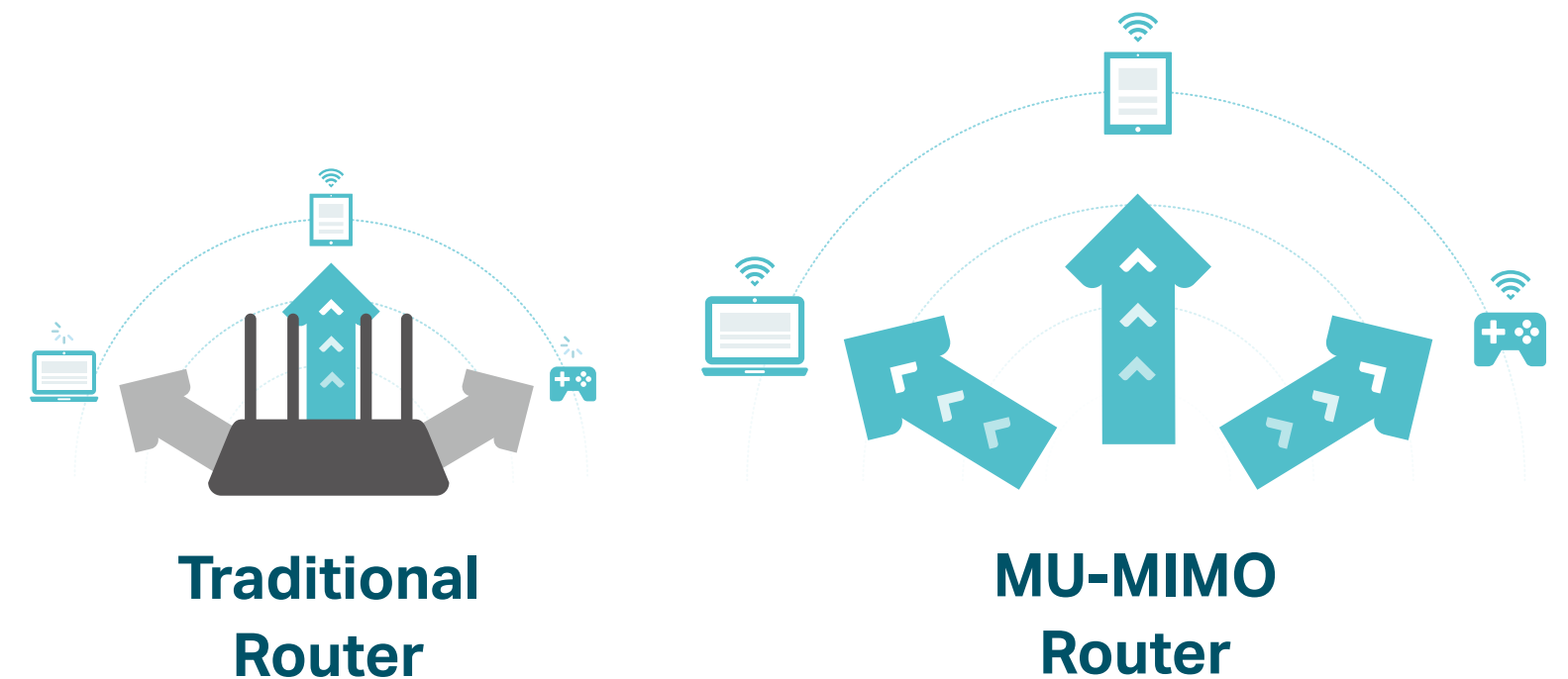

# Features



## Speed

- Ultimate Wireless Speed – 867 Mbps on 5 GHz + 400 Mbps on 2.4 GHz
- MU-MIMO – Simultaneously transfer data to multiple devices for 2× faster
- Support 802.11 ac – Provide a data transfer rate 3 times faster than 802.11n for each stream

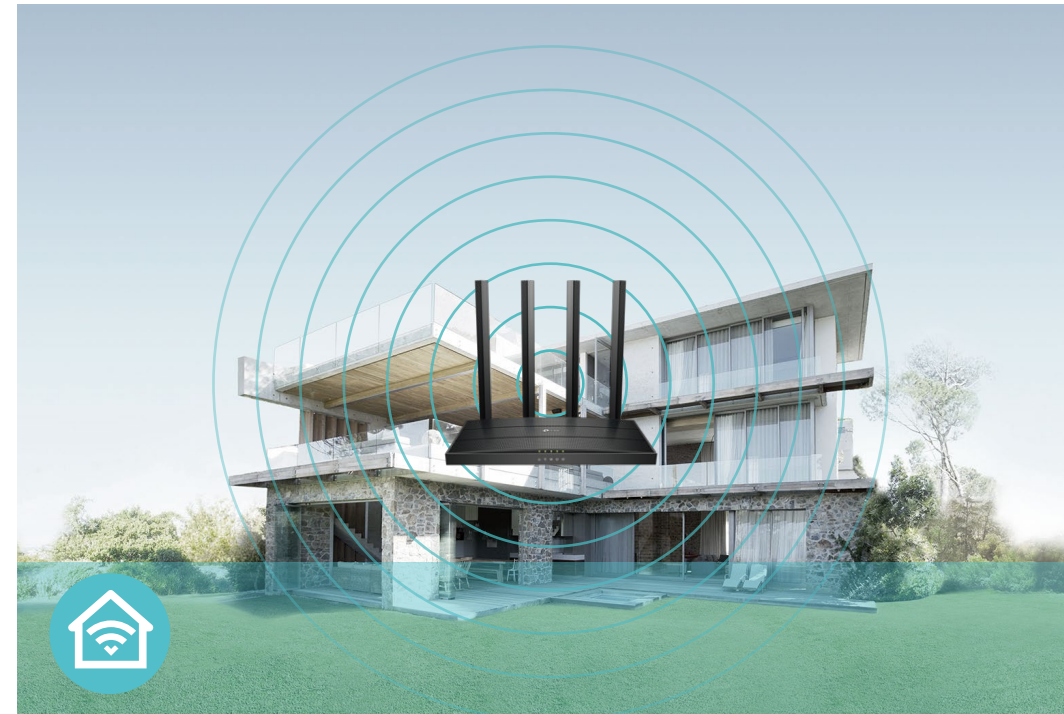

## Wi-Fi Range

- Ultimate Range Wi-Fi – Four external antennas deliver a Wi-Fi signal to every corner of your home, making all of your connections more efficient and stable



## Reliability

- IPTV – Support IGMP Proxy/Snooping, Bridge and Tag VLAN to optimize IPTV streaming
- Smart Connect – Intelligently switches each device's connection to the optimum available Wi-Fi band

# Features



## Easy Management

- Intuitive Web UI – Ensures quick and simple Installation without hassle
- Hassle-free Management with Tether App – Network management is made easy with the TP-Link Tether App, available on any Android and iOS device
- TP-Link ID – Binds the router to your TP-Link ID and other family member's accounts to manage the router



## Security

- Active Defense – Protect your home network with firewalls and wireless encryption
- Guest Network – Provide separate access for guests while securing the home network
- Parental Controls – Restricts internet access time and contents for children devices
- Access Control – Establish a whitelist or blacklist to allow or block certain devices from accessing the internet



## Ease of Use

- WPS – Makes secure wireless connection quick and easy with the push of a button
- Wi-Fi Schedule – The wireless network can be automatically off within a specified period when you do not need the wireless connection
- LED Control – Automatically turns your router's LEDs off within a specified period

# Specifications

## Hardware

- Ethernet Ports: 1× 10/100/1000 Mbps WAN Port, 4×10/100/1000 Mbps LAN Port
- Buttons: WPS/Wi-Fi Button, Power On/Off Button, Reset Button
- Antennas: 4 Fixed Omni Directional Antennas
- Dimensions (W x D x H): 8.5 × 4.6 × 1.2 in (215 × 117 × 32 mm)

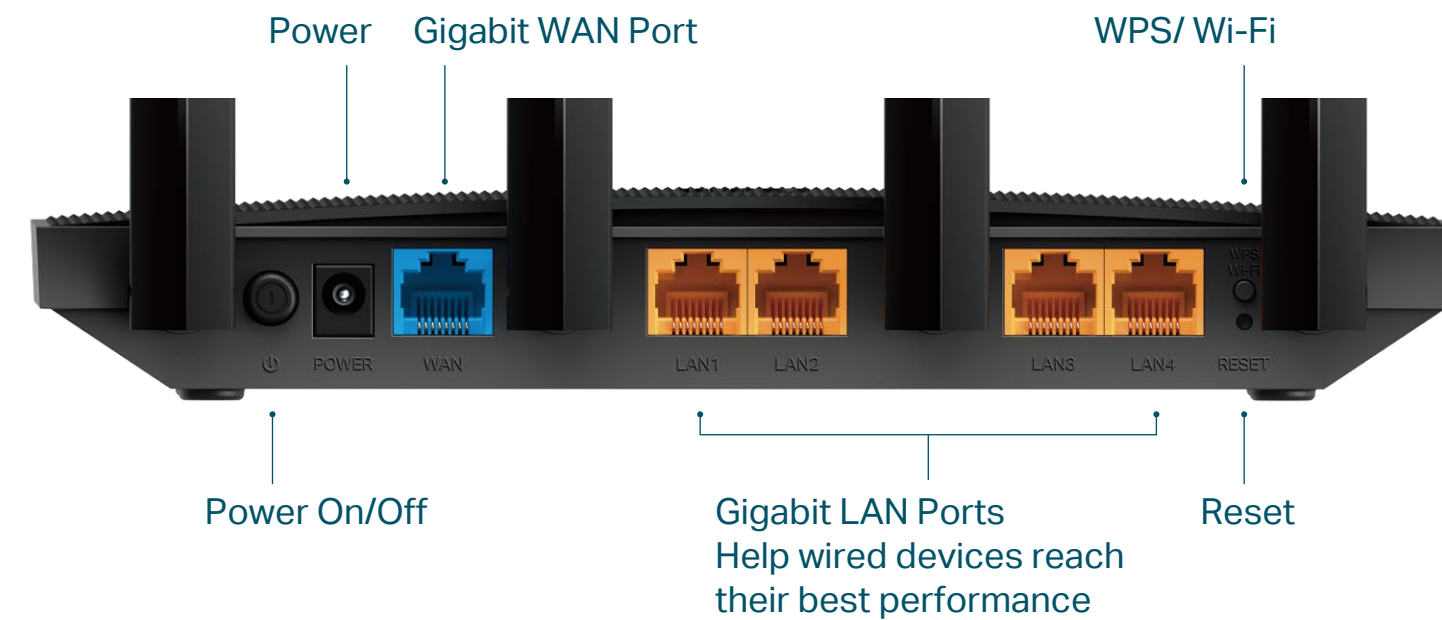

## Wireless

- Wireless: 867 Mbps on 5 GHz + 400 Mbps on 2.4 GHz
- Frequency: 2.4 GHz and 5 GHz
- Transmit Power:  
CE: <20dBm(2.4 GHz), <23dBm(5.15 GHz~5.25 GHz)  
FCC:<30dBm(2.4 GHz & 5 GHz)
- Reception Sensitivity:  
5 GHz:  
11a 6Mbps:-93dBm; 11a 54Mbps:-78dBm;  
11ac HT20 mcs8:-69dBm;11ac HT40 mcs9:-65dBm;  
11ac HT80 mcs9:-62dBm;  
2.4 GHz:  
11g 54Mbps:-78dBm;  
11n HT20 mcs7:-74dBm;  
11n HT40 mcs7:-71d
- Wireless Function: Enable/Disable Wireless Radio, WMM
- Wireless Security: WPA/WPA2, WPA-PSK/WPA2-PSK encryptions/WPA3

# Specifications

## Software

- Quality of Service: Device Prioritization
- WAN Type: Dynamic IP/Static IP/PPPoE/PPTP(Dual Access)/L2TP(Dual Access)
- Management: Access Control, Local Management, Remote Management
- DHCP: Server, DHCP Client List, Address Reservation
- Port Forwarding: Port Forwarding, Port Triggering, UPnP, DMZ
- Dynamic DNS: DynDns, NO-IP, TP-Link
- Access Control: Parental Controls, Local Management Control, White List, Black List
- Firewall Security: SPI Firewall, IP and MAC Address Binding
- Protocols: IPv4, IPv6
- Guest Network: 2.4 GHz Guest Network, 5 GHz Guest Network

## Others

- Certification:  
CE, FCC, RoHS
- System Requirements:  
Microsoft Windows 98SE/NT/2000/XP/Vista™/7/8/8.1/10, MAC OS, NetWare, UNIX or Linux  
  
Internet Explorer 11, Firefox 12.0, Chrome 20.0, Safari 4.0, or other Java-enabled browser  
  
Cable or DSL Modem  
  
Subscription with an internet service provider (for internet access)
- Environment:  
Operating Temperature: 0°C~40°C (32°F ~104°F)  
Operating Humidity: 10%~90% non-condensing
- Package Contents  
Wireless Router Archer A6  
  
Power Adapter  
  
RJ45 Ethernet Cable  
  
Quick Installation Guide

For more information, please visit

<https://www.tp-link.com/us/home-networking/wifi-router/archer-a6/>.html

Attention: This device may only be used indoors in all EU member states and EFTA countries.

Specifications are subject to change without notice. ©2022 TP-Link

This device complies with part 15 of the FCC Rules. Operation is subject to the following two conditions: (1) This device may not cause harmful interference, and (2) this device must accept any interference received, including interference that may cause undesired operation.

\*Maximum wireless signal rates are the physical rates derived from IEEE Standard 802.11 specifications. Actual wireless data throughput and wireless coverage are not guaranteed and will vary as a result of network conditions, client limitations, and environmental factors, including building materials, obstacles, volume and density of traffic, and client location.

\*Use of MU-MIMO requires clients to also support MU-MIMO.